

# GAS

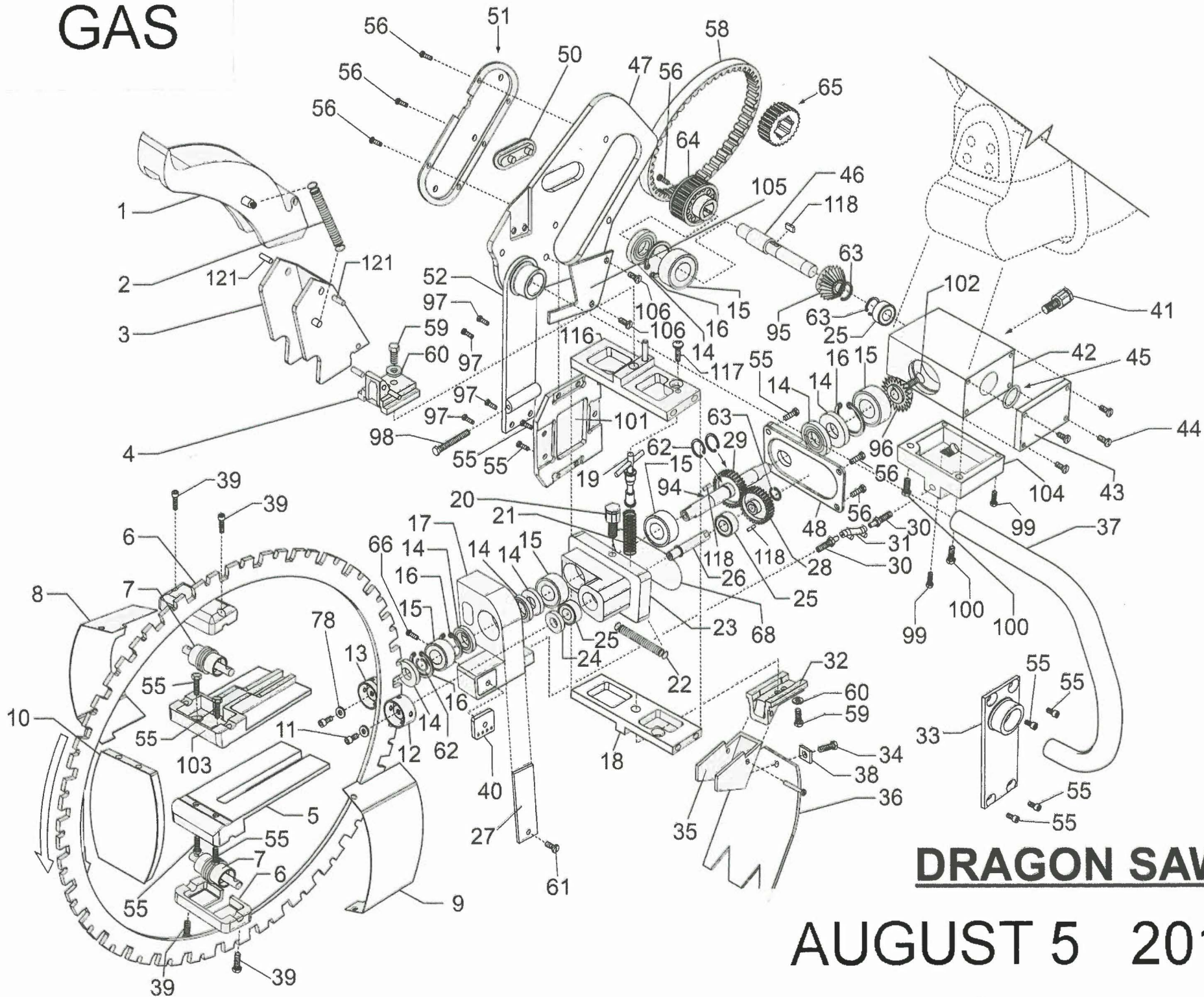

## DRAGON SAW

# AUGUST 5 2011

ITEM #	PART #	DESCRIPTION	QUANTITY	INFORMATION
1-1	EGHDS001-1	BLADE GUARD COMPLETE	1	
1	EGHDS001	BLADE GUARD	1	
2	EGHDS002	SPRING	1	
3	EGHDS003	UPPER GUARD	1	
4	GSD004	CLAMPING BLOCK FOR GAS	1	
5-1	EGHSD005-1	ADJUSTABLE ARM ASSEMBLY	1	Includes-5-7-8-9-10-39-55
5	EGHDS005	ROLLER ARM	2	
6	EGHDS006	ROLLER ARM COVER	2	
7	EGHSD007	GUIDE ROLLER	2	
8	EGHDS008	SHIELD GUIDE ROLLER LEFT	1	
9	EGHDS009	SHIELD GUIDE ROLLER RIGHT	1	
10	EGHDS010	SHIELD GUIDE ROLLER FRONT	1	
11	EGHDS011	HEX CAP SCREW	2	5/16-18X3/4"
12	EGHDS012	DRIVE ROLLER UPPER	1	
13	EGHDS013	DRIVE ROLLER LOWER	1	
14	EGHDS014	OIL SEAL	5	
15	EGHDS015	BEARING	4	1623-2RS
16	EGHDS016	C CLIP	2	
17	EGHDS017	COOLING BLOCK	1	
18	EGHDS018	SIDE PLATE U&L	2	
19	EGHDS019	ROLLER TENSIONER	1	
20	EGHDS020	AIR BREATHER # 1	1	
21	EGHDS021	SPRING ROLLER TENSION	1	
22	EGHDS022	SPRING # 2	1	
23	EGHDS023	TRANSMISSION	1	
24	EGHDS024	SEAL	1	
25	EGHDS025	BEARING	2	1616
26	EGHDS026	ROLLER SHAFT UPPER	1	
27	EGHDS027	WATER CHANNEL	1	
28	EGHDS028	SPUR GEAR # 1	1	
29	EGHDS029	SPUR GEAR # 2	1	
30	EGHDS030	FITTING-WATER	1	
31	EGHDS031	HOSE-WATER	1	

32	EGHDS032	CLAMP BLOCK LOWER	1	
33	EGHDS033	HANDLE BRACKET LOWER	1	
34	EGHSD034	HEX SCREW	1	1/4-20 X 7/8
35	EGHDS035	GUARD LOWER	1	
36	EGHDS036	GUARD RUBBER FLOP	1	
37	EGHDS037	HANDLE-FRONT	1	
38	EGHDS038	SQUARE WASHER	1	
39	EGHDS039	SOCKET CAP SCREW	4	10/32 X 7/8
40	EGHDS040	WATER INJECTION SKIP PLATE	1	
41	EGHDS041	VENT-GOR # 2	1	
42	GDS042	DRIVE GEAR BOX # 2	1	
43	GDS043	DRIVE GEAR BOX #2 END CAP	1	
44	GDS044	BOLT END CAP	4	
45	GDS045	O-RING - END CAP	1	70#125
46	GDS046	SHAFT # 1	1	
47	GDS047	PLATE-ADAPTER	1	
48	EGHDS048	COVER-TRANSMISSION	1	
49	EHDS049	SHAFT-TRANSMISSION	1	
50	GDS050	WASHER-PLATE	1	
51	GDS051	COVER	1	
52	GDS052	BRACKET-HANDLE EXTENTION	1	
53	EGHDS053	PLATE-BASE	1	
54	EHDS054	BRACKET-TOP HANDLE	1	
55	EGHDS055	SCREW-FLAT	14	1/4-20 X 3/4
56	EGHDS056	SCREW-FLAT	6	1/4-20 X 1/2
57	EGHDS057	SCREW-CAP	1	1/4-20 X 3/4
58	GDS058	BELT - 400-5M	1	
59	EGHDS059	BOLT	2	3/8-16 X 3/4
60	EGHDS060	WASHER-FLAT	2	
61	EGHDS061	BOLT	1	1/4-20X3/4-SCS-
62	EGHDS062	C-CLIP	3	5/8"
63	EGHDS063	C-CLIP	1	1/2"
64	GDS064	PULLEY-DRIVE BELT	1	
65	GDS065	PULLEY-MOTOR DRIVE	1	

66	EGDS066	BOLT-SKID PLATE	1	10-32X1
67	HDS067	GEAR BOX	1	
68	EGHDS068	O-RING	1	# 239
69	HDS069	VALVE BODY-HYDRAULIC	1	
70	HDS070	HANDLE	1	
71	HDS071	PLUNGER	1	
72	HDS072	COVER-GEAR BOX	1	
73	HDS073	HANDLE EXTENTION BAR	1	
74	HDS074	VALVE CAP	1	
75	HDS075	SPRING	1	
76	HDS076	STEM BLOCK	2	
77	HDS077	O-RING	1	#245
78	EGHDS078	WASHER-LOCK	1	5/16"
79	HDS079	SEAL-QUAD	1	
80	HDS080	SEAL-QUAD	1	
81	HDS081	SCREW	2	
82	HDS082	GEAR SMALL	1	
83	HDS083	GEAR LARGE	1	
84	HDS084	WASHER-LOCK	2	1/4"
85	HDS085	HOSE ASSEMBLY # 2	2	
86	HDS086	MOTOR CASAPPA	1	PLM10.5D0-----
87	HDS087	BOLT-HANDLE	1	
88	HDS088	HANDLE ASSEMBLY	1	
89	HDS089	HOSE ASSEMBLY # 3	1	
90	HDS090	HOSE ASSEMBLY # 4	1	
91	HDS091	INSULATOR-HEAT SMALL	1	
92	HDS092	INSULATOR-HEAT LARGE	1	
93	HDS093	SCREW SOCKET CAP	2	
94	GDS094	SHAFT-MAIN-GAS	1	
95	GDS095	GEAR-BEVEL#1	1	
96	GDS096	GEAR-BEVEL#2	1	
97	GDS097	BOLT	4	1/4X20X1 Flat
98	GDS098	BOLT-LONG TENTIONING	1	1/4X20X3-TAPBT
99	GDS099	BOLT-COOLER	2	6/32X5/8-SC

100	GDS100	BOLT-COOLER	2	10/32X1/2-SC
101	GDS101	PLATE-BASE	1	
102	GDS102	BOLT-END OF SHAFT	1	5/16X18X1"-SC
103	GDS103	CLAMP BLOCK-SHORT	1	
104	GDS104	COOLER-TRANSMITION	1	
105	GDS105	GUARD-FINGER	1	
106	GDS106	BOLT-FINGER GUARD	2	1/4-20X3/8"
106-1M	GDS106-1M	GAS MOTOR	1	6400 DOLMAR
107	EDS107	TRANSMISSION-ELECTRIC	1	
108	EDS108	O-RING	1	
109	EDS109	GEAR	1	
110	EDS110`	GEAR	1	
111	EDS111	MOTOR-110V	1	
111-1	EDS111-1	MOTOR-230V	1	
112	EDS112	BEARING	1	
113	HDS113	SEAL KIT HYDRO	1	
114	GDS114	SEAL KIT GAS	1	
115	EDS115	SEAL KIT ELECTRIC	1	
116	EGHDS116	SIDE PLATE U&L C/W PIN	1	
117	EGHDS117	BOLT	1	10-32X1/2" BHSCS
118	EGHDS118	KEY WAY	2	1/8" X 3/8"
119	HDS119	SPRING PIN	1	
120	HDS120	TRIGGER LOCK	1	
121	EGHDS121	DOWEL PIN-- GUARD STOP	4	1/4" X 1/2"
122	HDS122	SPRING--TRIGGER LOCK	1	
123	HDS123	FEMALE-HYDRO COUPLER	1	
124	HDS124	MALE-HYDRO COUPLER	1	